

PAGE 1 OF 2: EXISTING RESTRICTIONS ONLY

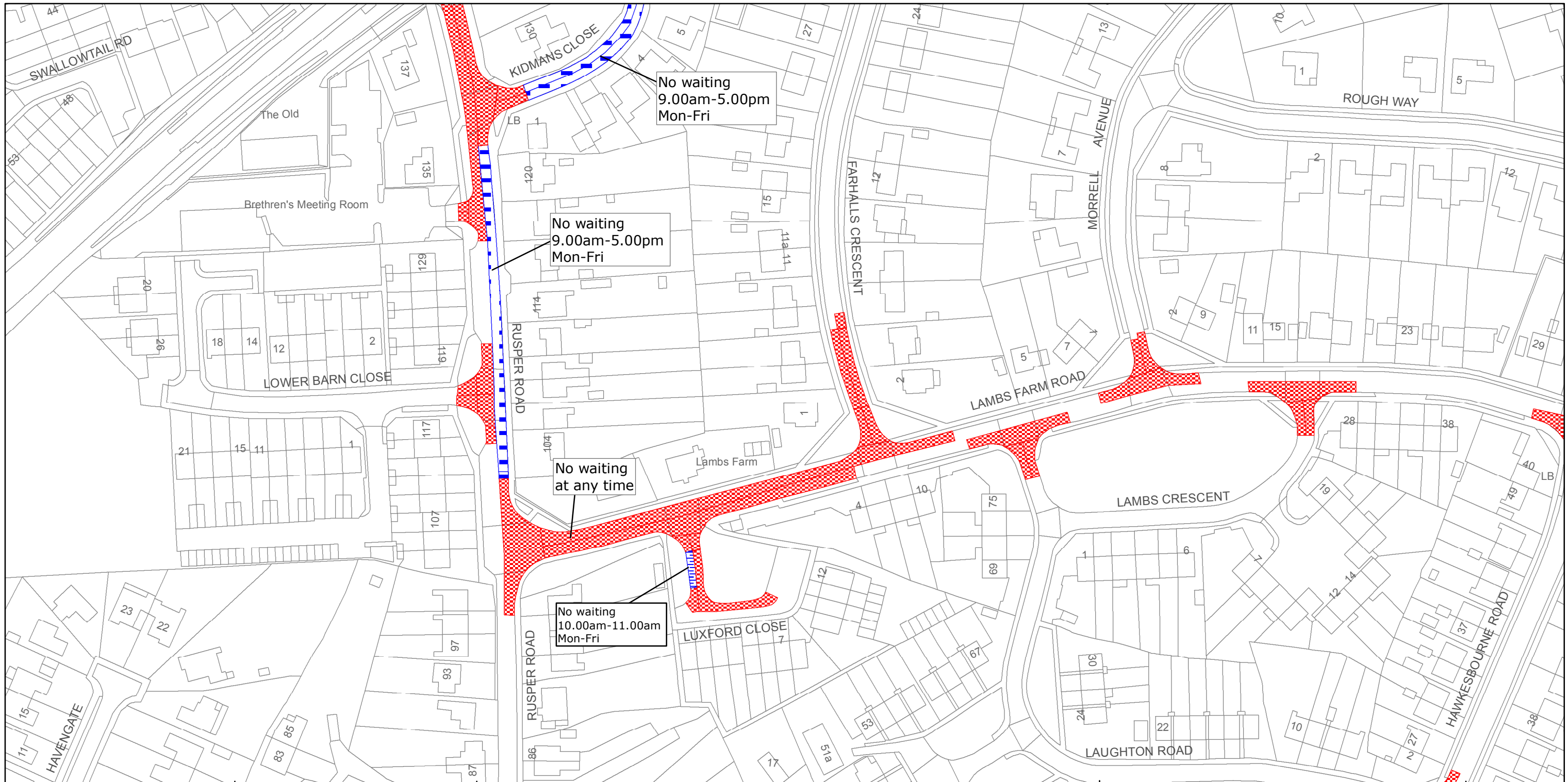

West Sussex County Council  
 Highways & Transport  
 The Grange  
 Tower Street  
 Chichester  
 West Sussex  
 PO19 1RH

HORSHAM DISTRICT: NORTH HORSHAM  
 WAITING RESTRICTIONS

TILE REF NO:  
 TQ1832SEN

SHEET ISSUE NO 5  
 SHEET ACTIVE FROM - 28/07/2014



SCALE:  
 1:1250  
 at A3 size

Reproduced from or based upon 2010 Ordnance Survey mapping with permission of the Controller of HMSO (c) Crown Copyright reserved.  
 Unauthorised reproduction infringes Crown copyright and may lead to prosecution or civil proceedings West Sussex County Council Licence No. 100018485

# PAGE 2 OF 2: PROPOSED CHANGES TO RESTRICTIONS (CIRCLED)

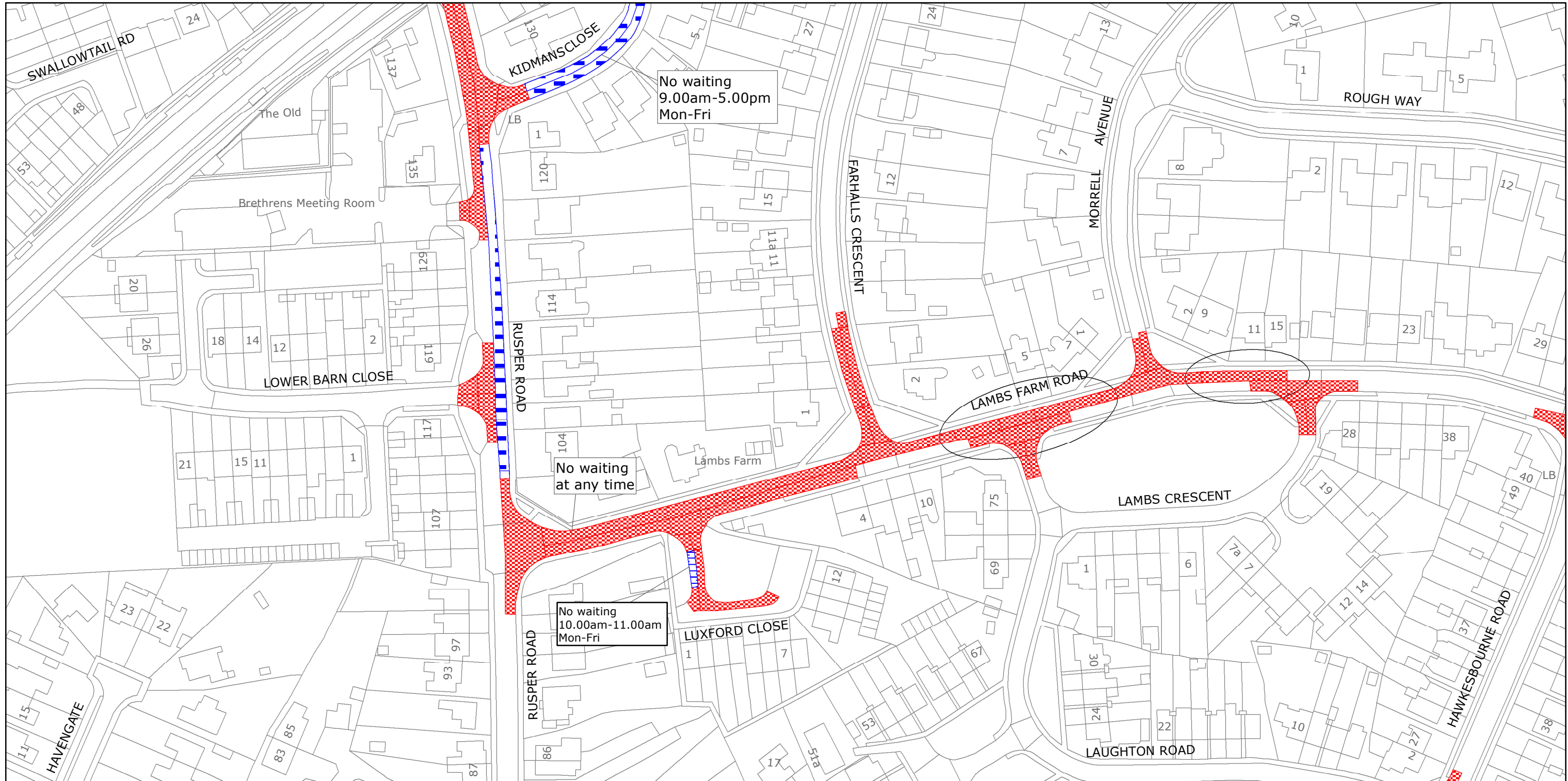

West Sussex County Council  
 Highways & Transport  
 The Grange  
 Tower Street  
 Chichester  
 West Sussex  
 PO19 1RH

HORSHAM DISTRICT: NORTH HORSHAM  
 PROPOSED WAITING RESTRICTIONS (08.07.2021)

Reproduced from or based upon 2021 Ordnance Survey mapping with permission of the Controller of HMSO (c) Crown Copyright reserved.  
 Unauthorised reproduction infringes Crown copyright and may lead to prosecution or civil proceedings West Sussex County Council Licence No. 100018485

TILE REF NO:  
**TQ1832SEN**

SHEET ISSUE NO 6A\_HON2106  
 SHEET ACTIVE FROM - DD.MM.YYYY



SCALE:  
 1:1250  
 at A3 size