

- LEGEND**
- ▬ Road Sign
  - - - Site Extents
- NOTES**
- All signs and road markings to be in accordance with the Traffic Signs Regulations and General Directions 2015.
  - Positioning and locations to be in accordance with the guidance provided in the Department of Transport Traffic Signs Manual.
  - Materials, processes and quality of workmanship employed in the installation of signing and marking to be in accordance with the Specification for Highway Works.
  - Refer to WSCC 278/38 Highway Agreement Standard Details drawings 01-36 and revision thereof.

F	30.03.21	SIGNS UPDATED	DJP	RH	GW
E	17.03.21	SIGNS UPDATED	DJP	RH	GW
D	02.03.21	SIGNS UPDATED	DJP	RH	GW
C	25.02.21	SIGNS UPDATED	TW	DJP	RH
B	28.01.21	UPDATED AS PER WSCC COMMENTS	IC	DJP	RH
A	30.10.20	TENDER ISSUE	IC	DJP	GW
Rev	Date	Description	Drm	Chk	App

This drawing has been specifically prepared to meet the requirements of the named client and may contain design and innovative features which differ from conventional design standards.

**PROJECT CENTRE**

38 Foundry Street  
Brighton  
BN1 4AT  
Tel: 01273 627166  
Mail: info@projectcentre.co.uk  
Web: www.projectcentre.co.uk

ISO 9001 Quality Management  
FS 77166

Client	 WORTHING BOROUGH COUNCIL				
Project	PORTLAND ROAD HIGH STREET REGENERATION				
Drawing Title	PROPOSED SIGNS AND ROAD MARKINGS				
Drawing Status	TENDER				
Drawn	Designed	Date	Scale	Size	
IC	DP	02.09.2020	1:250	A1	
Drawing No.	100006603-4-120-01				Rev
					F

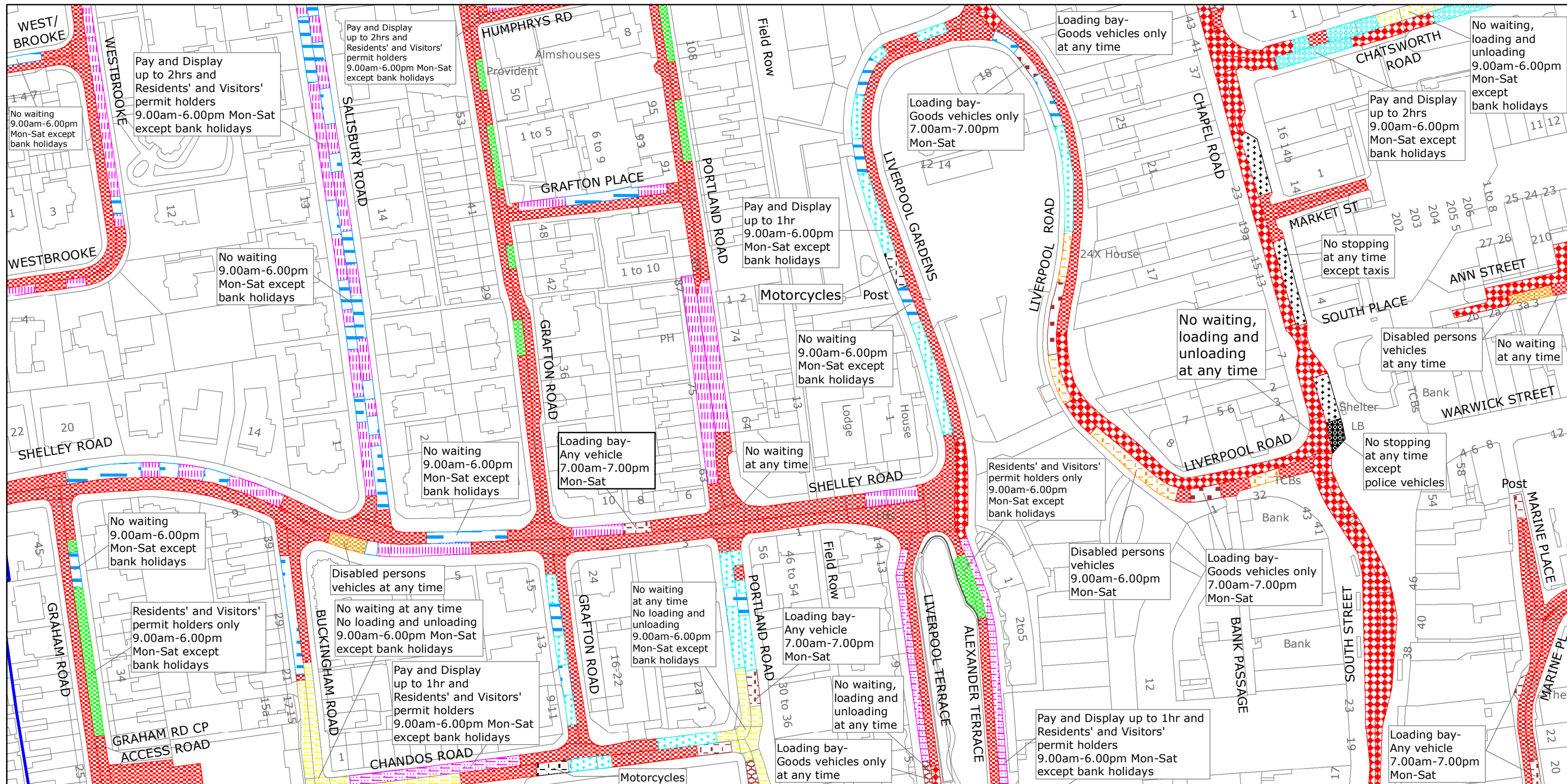

West Sussex County Council  
 Highways & Transport  
 The Grange  
 Tower Street  
 Chichester  
 West Sussex  
 PO19 1RH

WORTHING BOROUGH: CENTRAL WARD  
 WAITING RESTRICTIONS

Reproduced from or based upon 2019 Ordnance Survey mapping with permission of the Controller of HMSO (c) Crown Copyright reserved.  
 Unauthorised reproduction infringes Crown copyright and may lead to prosecution or civil proceedings West Sussex County Council Licence No. 100018485

TILE REF NO:  
 TQ1402NES

SHEET ISSUE NO 9  
 SHEET ACTIVE FROM - 22/07/2019



SCALE:  
 1:1250  
 at A3 size

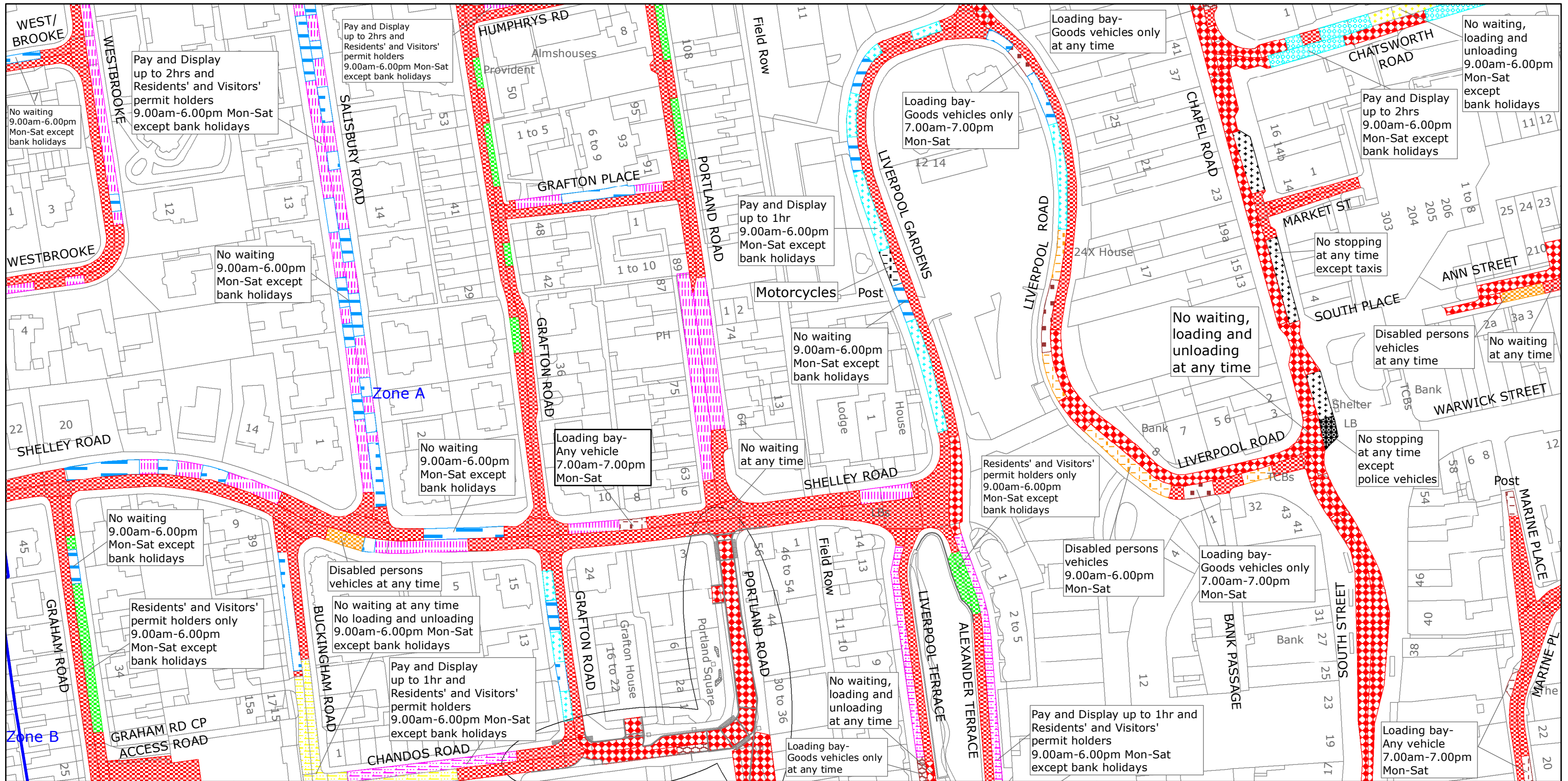

West Sussex County Council  
 Highways & Transport  
 The Grange  
 Tower Street  
 Chichester  
 West Sussex  
 PO19 1RH

**WORTHING BOROUGH: CENTRAL WARD**  
**PROPOSED WAITING RESTRICTIONS (29.04.2021)**

Reproduced from or based upon 2021 Ordnance Survey mapping with permission of the Controller of HMSO (c) Crown Copyright reserved.  
 Unauthorised reproduction infringes Crown copyright and may lead to prosecution or civil proceedings West Sussex County Council Licence No. 100018485

**TILE REF NO:**  
**TQ1402NES**

SHEET ISSUE NO 10\_WOR9017  
 SHEET ACTIVE FROM - DD/MM/YYYY



**SCALE:**  
**1:1250**  
 at A3 size

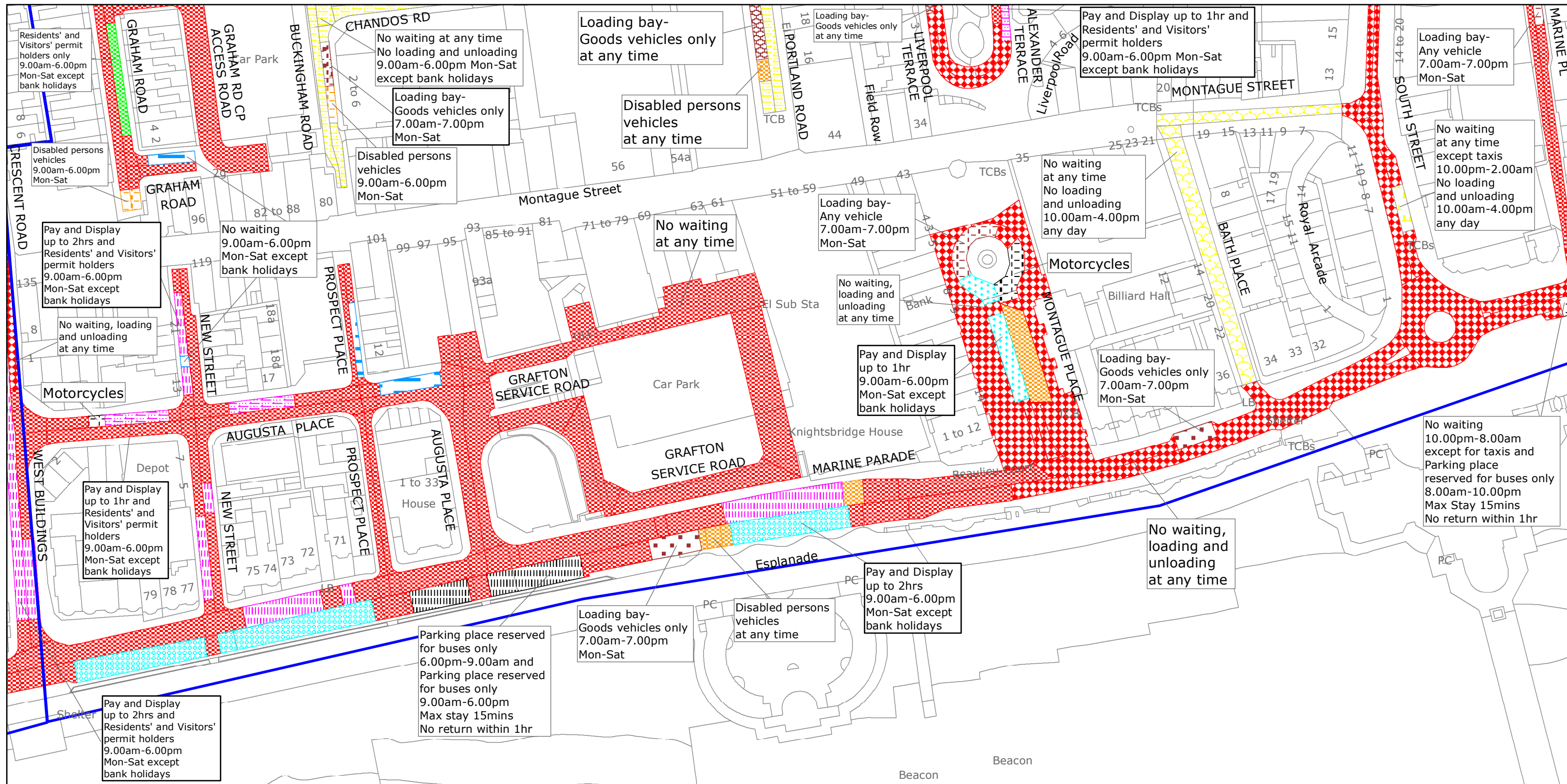

West Sussex County Council  
 Highways & Transport  
 The Grange  
 Tower Street  
 Chichester  
 West Sussex  
 PO19 1RH

WORTHING BOROUGH: CENTRAL WARD  
 WAITING RESTRICTIONS

Reproduced from or based upon 2019 Ordnance Survey mapping with permission of the Controller of HMSO (c) Crown Copyright reserved.  
 Unauthorised reproduction infringes Crown copyright and may lead to prosecution or civil proceedings West Sussex County Council Licence No. 100018485

TILE REF NO:  
 TQ1402SEN

SHEET ISSUE NO 9  
 SHEET ACTIVE FROM - 22/07/2019



SCALE:  
 1:1250  
 at A3 size

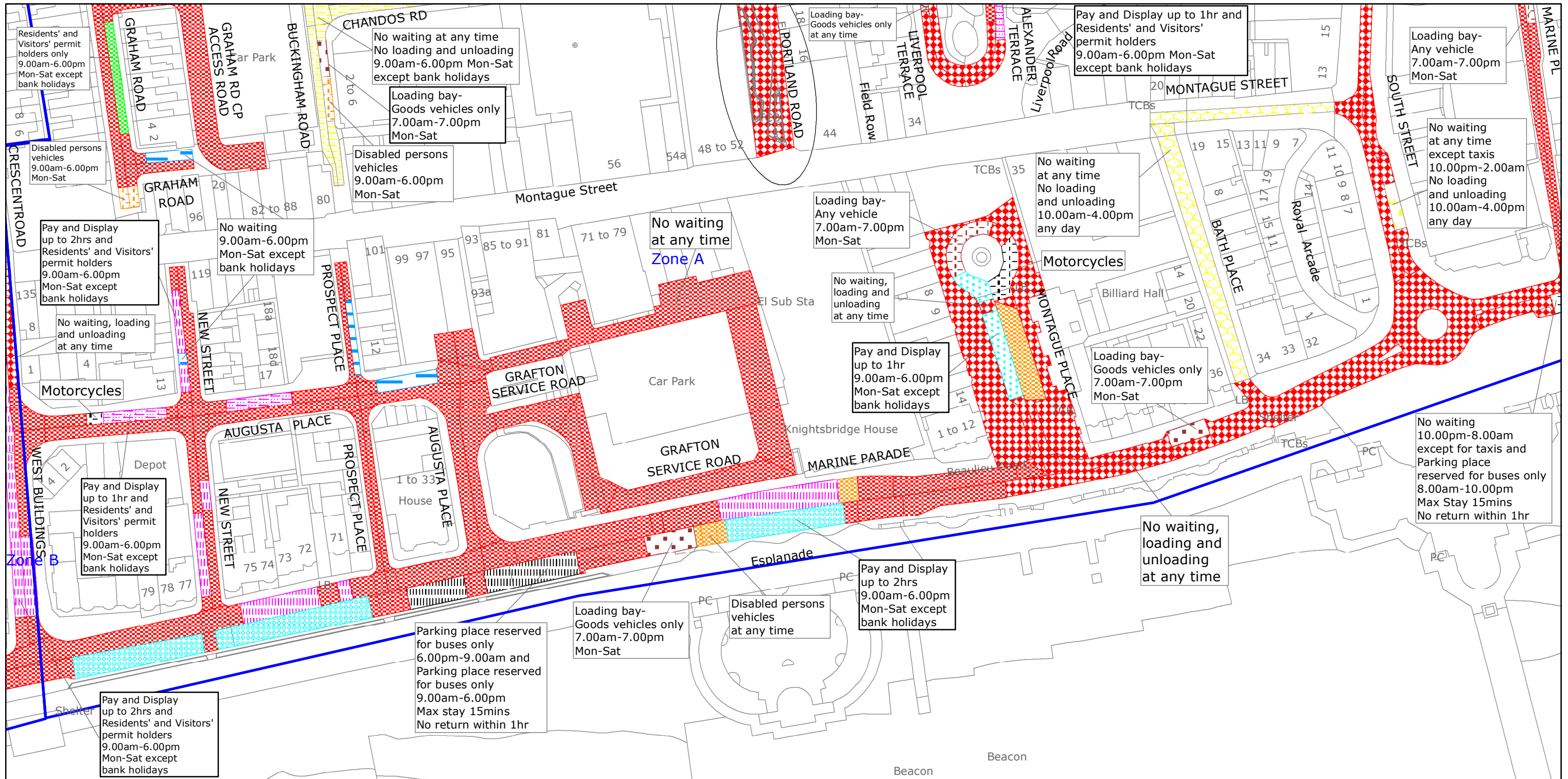

West Sussex County Council  
 Highways & Transport  
 The Grange  
 Tower Street  
 Chichester  
 West Sussex  
 PO19 1RH

WORTHING BOROUGH: CENTRAL WARD  
 PROPOSED WAITING RESTRICTIONS (01.03.2021)

Reproduced from or based upon 2021 Ordnance Survey mapping with permission of the Controller of HMSO (c) Crown Copyright reserved.  
 Unauthorised reproduction infringes Crown copyright and may lead to prosecution or civil proceedings West Sussex County Council Licence No. 100018485

TILE REF NO:  
 TQ1402SEN

SHEET ISSUE NO 10\_WOR9017  
 SHEET ACTIVE FROM - DD/MM/YYYY



SCALE:  
 1:1250  
 at A3 size